

Charge Amps **Aura**



User Manual

English

Charge Amps Aura 131502

Charge Amps Aura 131503



Respect the environment! Must not be discarded with household waste! This product contains electrical or electronic components. Leave the product for separate collection and proper treatment at a designated location e.g. the local authority's recycling station.



In conformity with the relevant EU directives.

Neglecting to follow and carry out the directions, instructions and safety precautions in this User Manual implies that any warranty provisions will be cancelled and that Charge Amps can reject any and all claims for compensation in connection with any injuries/damage or incidents – direct or indirect – that are a result of such negligence.

Charge Amps AB does not give any warranties as to the accuracy or completeness of this document and shall have no liability for the consequences of using such information. Charge Amps AB reserves the right to make changes to information published in this document without notice. Visit www.chargeamps.com for the latest document releases.

© Copyright Charge Amps AB. All rights reserved. Copying, amending and translating are strictly forbidden without prior written approval from Charge Amps AB.

1 Safety

WARNING! Read all instructions before installation.

- Improper use may create a risk of personal injury.
- The product must only be installed or opened by a qualified electrician in accordance with the Installation Manual.
- National usage requirements and restrictions apply.
- Only use this product for charging compatible electric vehicles.
- Never use an adapter between the EV socket-outlet and the charging cable.
- Cord extension sets are not allowed to be used.
- Inspect the product for visible damage before use.
- Never attempt to repair or use the product if it is damaged.
- Do not immerse the product in water, subject it to physical abuse or insert foreign objects in any part of the product.
- Never attempt to disassemble the product in any way.
- The owner is responsible for informing users of the compatibility of any charging point.

2 Technical data

| | |
|---|--|
| Charging mode | Mode 3 |
| EV power supply identifier |  |
| Metering | 1 to 3 phase voltage, current and power |
| Socket | Type 2, up to 2x22 kW* |
| Rated voltage (U _n) | 230/400 V |
| Rated insulation voltage (U _i) | 250/400 V |
| Rated impulse withstand voltage (U _{imp}) | 4 kV |
| Rated frequency (f _n) | 50 Hz |
| Rated current (I _n) | 63 A |
| Rated diversity factor (RDF) | 1 (can be lowered if used together with a load balancing functionality) |
| Dimensions (W x D x H) | 367 x 159 x 405 mm |
| Characteristics of power supply and output | AC EV supply equipment connected to AC supply network, permanently connected. |
| Assembly type | AECVS |
| RFID | Type: ISO/IEC 14443 Typ A 13.56MHz Mifare Range: 13.553 – 13.567 MHz Output: 31 dBm |

Wi-Fi**

Type: 802.11 b/g/n
Range: 2400 – 2500 MHz
Max output: 20/17/14 dBm@802.11
b/g/n

**Cellular networks communication
(only applies to Charge Amps Aura
with product number 131503)**

Type: GSM, GPRS, EDGE, UMTS/
HSPA+, LTE
Range: 698 – 960 / 1710 – 2690 MHz
Max. output: 33 dBm@GSM, 24 dBm@
WCDMA, 23 dBm@LTE
SIM Card: Standard SIM (25mm x
15mm).

*The charging power is subject to external conditions, such as outside temperature, car battery state of charge, or if there's a load balancing function or charging schedule applied.

**The Charge Amps Aura Wi-Fi access point is deactivated if one of the RJ45 ports are connected.

3 Product overview

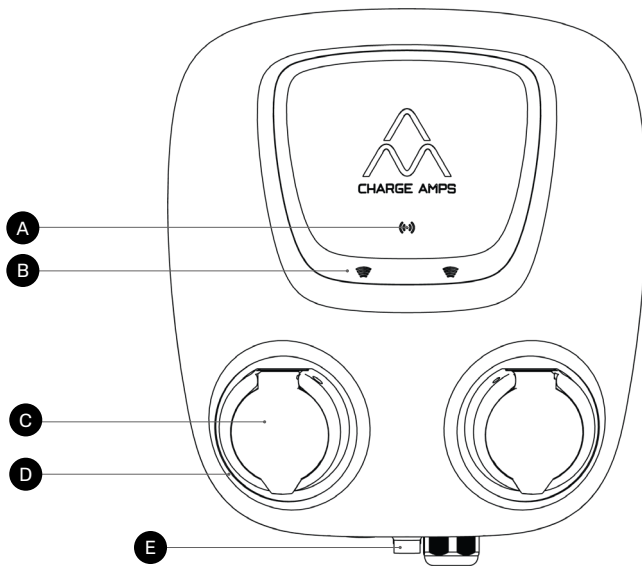

- A** RFID reader
- B** RFID light
- C** EV socket-outlet
- D** Socket light
- E** Cylinder light

3.1 Package contents

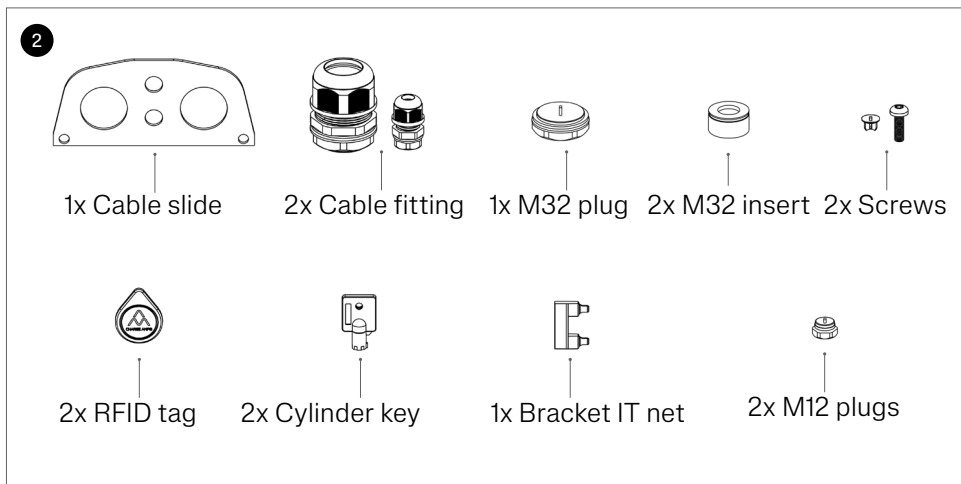
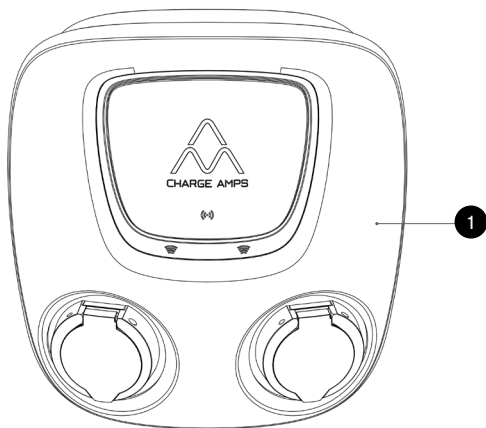

❶ Charge Amps Aura

❷ Accessories:

- Cable slide
- Cable fitting for power (M32): 13 - 17.5 mm and 17 - 25 mm
- Cable fitting for data (M12): 4 - 8 mm
- Plugs for non-used cable entries
- M32 insert only
- Screws
- 2x RFID tags
- 2x Cylinder lock keys
- 1x Bracket for IT network connection (MPN: 2016-433)

Additional contents:

- Document with serial number and password
- Quick Guide

4 Use

4.1 Add RFID tag

N.B. Make sure your installer has given you the access to Charge Amps Admin Portal to be able to manage RFID tags.

Add RFID tag using the Charge Amps cloud service:
<https://my.charge.space/admin>

4.2 Start and stop charging without RFID identification

1. Initiate charging by connecting the EV connector to the car. Then connect the EV plug to the EV socket-outlet.
2. Stop charging by disconnecting the EV connector from the car and disconnect the EV plug from the EV socket-outlet.

4.3 Start and stop charging with RFID identification

1. Initiate charging by connecting the EV connector to the car. Then connect the EV plug to the EV socket-outlet.
2. Briefly hold the RFID tag in front of the RFID reader to initiate charging.

N.B: If the other EV socket-outlet is not in use, it will turn dark and be unavailable for 5 minutes during the verification of the RFID tag. If no RFID tag has been verified during these 5 minutes, charging needs to be initiated remotely or reactivated by unplugging and reconnecting the vehicle connector.

3. Stop charging by disconnecting the EV connector from the car and disconnect the EV plug from the EV socket.

4.4 Cable lock

During charging, the cable lock on the charging station is automatically activated.

To permanently lock the EV charging cable to Charge Amps Aura while not charging, use Charge Amps App or cloud.

4.5 Cloud connectivity

Charge Amps Cloud and Charge Amps App are available for Charge Amps Aura connected to Charge Amps as the cloud provider.

Charge Amps App

Please download Charge Amps App for full control, adjusting settings and enabling smart charging and scheduling.



Charge Amps Cloud

Please create an account in the Charge Amps Cloud to configure, control and manage your charger via our web interface.



<https://my.charge.space/>

Full product information

Visit www.chargeamps.com for Charge Amps Aura Installation Manual, Charge Amps Aura User Manual and other product documentation.



<https://www.chargeamps.com/product/charge-amps-aura/>

4.6 Detect earth fault and test the RCD

Charge Amps Aura has a built-in RCD function that needs to be tested twice a year. An earth fault is indicated by a steady red light on the socket lights.

Test and reset the built-in RCD function of the two sockets by following the steps below.

Recommended tools:

- The cylinder key from the package content to unscrew the front cover.
- A charging cable.
- Access to an electric vehicle to start a charging session.

1. Use the cylinder key to unlock the front cover and remove the front cover by a pull from the bottom.

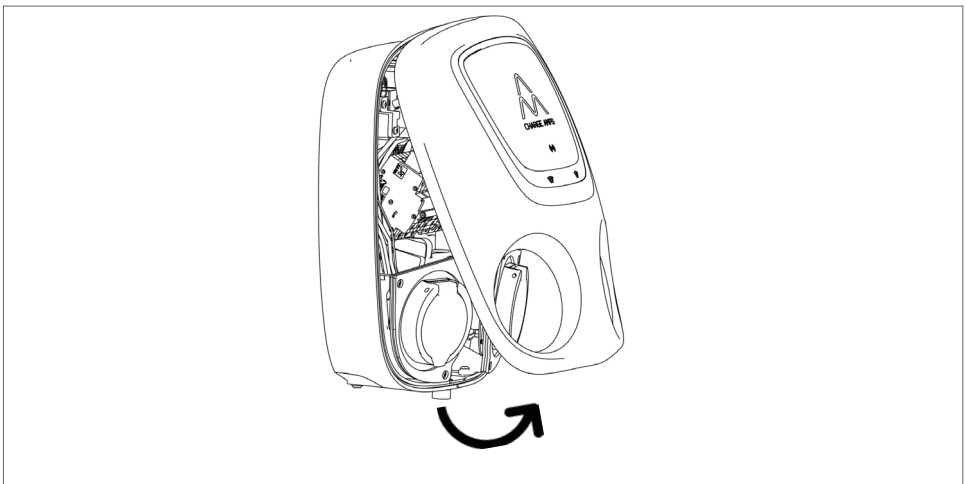

2. Connect the electric vehicle to the right hand socket of Charge Amps Aura using the charging cable.
3. If RFID authentication is enabled, briefly hold the RFID tag in front the RFID reader to initiate a charging session.
4. When the charging session has started, press your finger on the right hand side of the test button.
5. Charging will be aborted, and a steady red light will show on the socket lights which indicates a ground fault.
6. Reset the RCD by disconnecting the charging cable from Charge Amps Aura and reset internal circuit breakers (if tripped).
7. A steady green light will show on the socket lights which indicates that the RCD has been reset.
8. Repeat the same steps for the left socket.

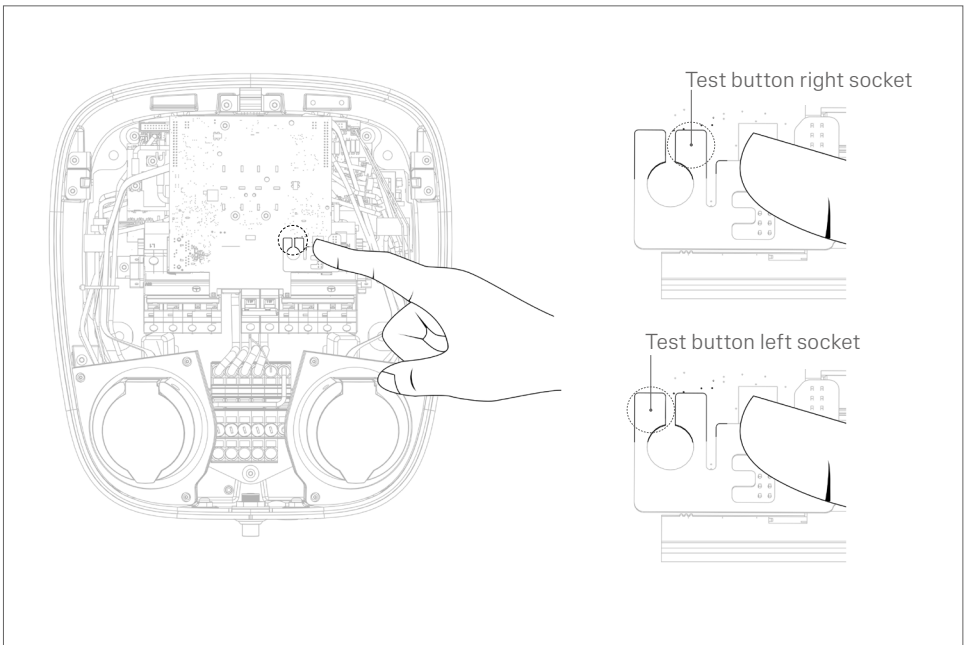

9. Once both the sockets have been tested, reassemble Charge Amps Aura by inserting the front cover, making sure no cables interfere with the front cover, and lock the cover in place.

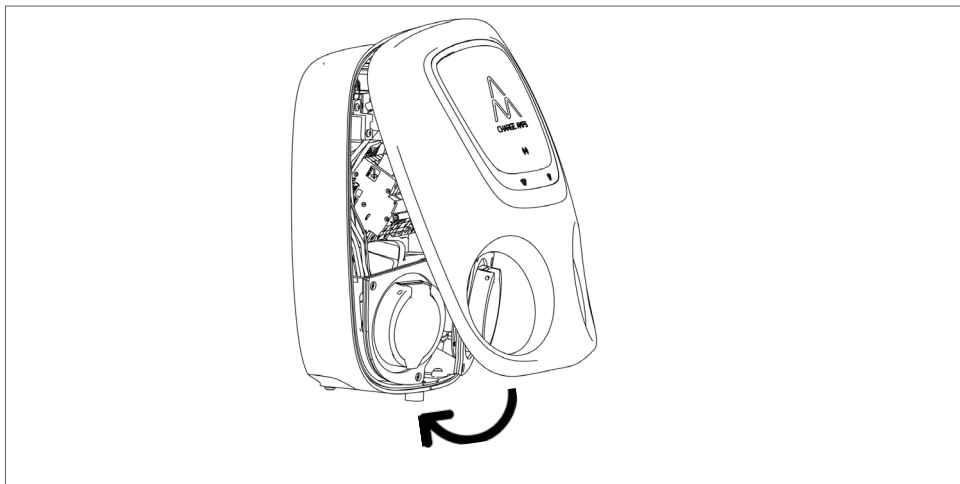

4.7 LED indications

4.7.1 General

| Status | Socket light | RFID light |
|--|---|------------|
| Ready for charging | Green light | - |
| Charging | Blue light | - |
| Charging complete (paused by vehicle) | Yellow light | - |
| Charging paused (paused by Aura) | Flashing blue light/yellow - steady light* | - |

* Depending on version

4.7.2 RFID tag verification

| Status | Socket light | RFID light |
|----------------------------------|--------------|---------------------|
| Waiting for RFID verification | Yellow light | Flashing blue light |
| RFID tag not approved | Yellow light | Red light* |
| RFID tag approved | - | Green lights up |

* Auto-return to "Waiting for RFID verification"

4.7.3 Other

| Status | Socket light | RFID light |
|---|--------------|------------|
| Error | Red light | No light |
| Earth fault detected | Red light | No light |
| EV socket-outlet not available for use | No light | No light |

5 Maintenance

5.1 Regular maintenance

N.B: Never spray water or any other liquid directly on to the product.

- Visually check that the EV socket-outlet is free from damage.
- The outside of the product must be regularly wiped with a clean, dry cloth to remove dirt and dust.
- Do not use detergent to clean any of the product's components.

5.2 Preventative maintenance

N.B: Preventative maintenance should be performed by a qualified electrician once or twice each year to check that Charge Amps Aura is in good condition.

- Remove the front cover and make a visual check of the cable connections.
- Test the internal RCD twice a year. See the instructions for how to test and reset the internal RCD in this User Manual.

6 Product support and service

If you have any questions or problems with the product, support is always available. To find answers to your questions most quickly: Read through this User Manual to check whether your questions are answered here.

If your question is not answered in the User Manual, please:

1. Contact your supplier or cloud provider.
2. If you need service or repair, start by contacting the supplier from whom you purchased the product.
3. For additional information, visit our Help Center at: www.chargeamps.com/support.

7 Warranty

Warranty terms may differ from market to market. Contact your supplier regarding the warranty terms.

www.chargeamps.com

Charge Amps AB (publ)
Frösundaleden 2B, 8th floor
SE-169 75 Solna, Sweden